



Yates County Planning Board Referral Form

Referral # 2019-29
County Use Only

Date Received 9-9-2019

Revised 1/2014

Municipality and Referring Agency Town of Starkey

Project Address 4250 RT 14 Dundee Project Tax Map # _____

Zoning District Starkey

Applicant (Name & MAILING) Christian Zimmerman

5009 Bigelow Hill Rd Dundee Email _____

Property Owner (Name & MAILING) Same

Email _____

Reason for Referral (Prox. to Cty Rd., State Rd., Muni Boundary, etc.) _____

Application Type

Project Description

- Area Variance
- Use Variance
- Special Use Permit
- Site Plan
- Subdivision
- Text Amendment
- Map Amendment
- Other

We want to place a 3,000 gal
fuel tank at our propane bulk
plant to fuel the bob tail trucks

Supporting Documents Required (IF N/A, include explanation)

- Municipal Application
- Tax Map or Plat
- SEQR
- Site Plan *
- Variance Criteria **
- Subdivision Plat For Subdivision Referrals Only
- Other

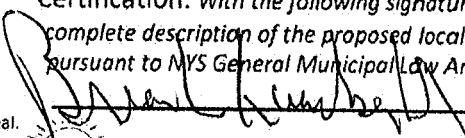
Certification: *With the following signature I certify that this application provides a complete description of the proposed local action and is a complete application pursuant to NYS General Municipal Law Article 12b, Section 239-m, part c.*
 _____, Referring Official

*If Site Plan Review, Site Plan **MUST** be detailed and meet the municipal requirements.

All Variance referrals (Area/Use) **MUST include detailed justifications associated with reason/s for appeal.



Provision of required information is the responsibility of the referring agency. Failure to provide such information may result in a significant delay in processing.

Submit To: Yates County Planning Department, Sbonshak@yatescounty.org or 417 Liberty St. Suite 1093, Penn Yan, NY 14527

Town Of Starkey

APPLICATION FOR USE PERMIT

Application fee: \$50.00

Permit NO. 2016-PB-6

Date: 4-20-16

Name: Christian Zimmerman

Address: 5009 Bigelow Hill Rd

Dundee PO Box: _____

Phone Number: 243-8282 City: _____ State: Ny

Zip Code: 14837 Zoning district: Starkey

E-Mail Address: Sheldon Dot Martin @ Frontier Dot Com

TO ZONING OFFICER:

Under the provisions of the Starkey Zoning Ordinance, I (We) Finger Lakos Property

Residing at 5009 Bigelow Hill Rd hereby apply for a use permit for a use described in the Zoning schedule of use controls as:

- Permitted Principal Subdivision
- Permitted Accessory
- Special use

The property at which the use hereafter specified will be conducted is located at 4250 RT 14 Dundee Ny 14837

In a district designated as C-1
(A-1, R-1, R-2, R-R, C-1, M-1, L-C)

The specific use (s) is (are) as follows: 3,000 gallon Fuel Tank
For Diesel For Fuel Delivery Trucks - no sales
of Diesel

Accepted Date: 4-20-16

Bruce Luach

Zoning & Building Officer

Applicant Signature

Short Environmental Assessment Form

Instructions for Completing

Part 1 - Project Information. The applicant or project sponsor is responsible for the completion of Part 1. Responses become part of the application for approval or funding, are subject to public review, and may be subject to further verification. Complete Part 1 based on information currently available. If additional research or investigation would be needed to fully respond to any item, please answer as thoroughly as possible based on current information.

Complete all items in Part 1. You may also provide any additional information which you believe will be needed by or useful to the lead agency; attach additional pages as necessary to supplement any item.

Part 1 - Project and Sponsor Information			
Finger Lakes Propane LLC			
Name of Action or Project:			
Christian Propane Bulk Plant			
Project Location (describe, and attach a location map):			
4250 RT 14 Dundee NY 14837			
Brief Description of Proposed Action:			
We want to Place a 3000 gal Fuel Tank To fuel the Bob tail trucks			
Name of Applicant or Sponsor:		Telephone: 607-243-8282	
Christian Zimmerman		E-Mail: Sheldon DOT martin @ Frontier DOT co	
Address:			
5009 Bigelow Hill Rd.			
City/PO:		State:	Zip Code:
Dundee NY 14837			
1. Does the proposed action only involve the legislative adoption of a plan, local law, ordinance, administrative rule, or regulation?			
If Yes, attach a narrative description of the intent of the proposed action and the environmental resources that may be affected in the municipality and proceed to Part 2. If no, continue to question 2.			
2. Does the proposed action require a permit, approval or funding from any other governmental Agency?			
If Yes, list agency(s) name and permit or approval:			
3.a. Total acreage of the site of the proposed action?			
b. Total acreage to be physically disturbed?			
c. Total acreage (project site and any contiguous properties) owned or controlled by the applicant or project sponsor?			
4. Check all land uses that occur on, adjoining and near the proposed action			
<input type="checkbox"/> Urban <input type="checkbox"/> Rural (non-agriculture) <input type="checkbox"/> Industrial <input checked="" type="checkbox"/> Commercial <input checked="" type="checkbox"/> Residential (suburban)			
<input type="checkbox"/> Forest <input type="checkbox"/> Agriculture <input type="checkbox"/> Aquatic <input type="checkbox"/> Other (specify): _____			
<input type="checkbox"/> Parkland			

5. Is the proposed action: a. A permitted use under the zoning regulations?	NO	YES	N/A
			✓
b. Consistent with the adopted comprehensive plan?			✓
6. Is the proposed action consistent with the predominant character of the existing built or natural landscape?	NO	YES	
			✓
7. Is the site of the proposed action located in, or does it adjoin, a state listed Critical Environmental Area? If Yes, identify: _____	NO	YES	
	✓		
8. a. Will the proposed action result in a substantial increase in traffic above present levels?	NO	YES	
	✓		
b. Are public transportation service(s) available at or near the site of the proposed action?			
c. Are any pedestrian accommodations or bicycle routes available on or near site of the proposed action?			✓
9. Does the proposed action meet or exceed the state energy code requirements? If the proposed action will exceed requirements, describe design features and technologies: _____	NO	YES	
			✓
10. Will the proposed action connect to an existing public/private water supply? [If Yes, does the existing system have capacity to provide service? <input type="checkbox"/> NO <input type="checkbox"/> YES] If No, describe method for providing potable water: _____	NO	YES	
	✓		
11. Will the proposed action connect to existing wastewater utilities? [If Yes, does the existing system have capacity to provide service? <input type="checkbox"/> NO <input type="checkbox"/> YES] If No, describe method for providing wastewater treatment: _____	NO	YES	
	✓		
12. a. Does the site contain a structure that is listed on either the State or National Register of Historic Places?	NO	YES	
	✓		
b. Is the proposed action located in an archeological sensitive area?			
13. a. Does any portion of the site of the proposed action, or lands adjoining the proposed action, contain wetlands or other waterbodies regulated by a federal, state or local agency?	NO	YES	
	✓		
b. Would the proposed action physically alter, or encroach into, any existing wetland or waterbody? If Yes, identify the wetland or waterbody and extent of alterations in square feet or acres: _____			
14. Identify the typical habitat types that occur on, or are likely to be found on the project site. Check all that apply: <input type="checkbox"/> Shoreline <input type="checkbox"/> Forest <input checked="" type="checkbox"/> Agricultural/grasslands <input type="checkbox"/> Early mid-successional <input type="checkbox"/> Wetland <input type="checkbox"/> Urban <input type="checkbox"/> Suburban			
15. Does the site of the proposed action contain any species of animal, or associated habitats, listed by the State or Federal government as threatened or endangered?	NO	YES	
	✓		
16. Is the project site located in the 100 year flood plain?	NO	YES	
	✓		
17. Will the proposed action create storm water discharge, either from point or non-point sources? If Yes, a. Will storm water discharges flow to adjacent properties? <input type="checkbox"/> NO <input type="checkbox"/> YES	NO	YES	
	✓		
b. Will storm water discharges be directed to established conveyance systems (runoff and storm drains)? If Yes, briefly describe: _____			

18. Does the proposed action include construction or other activities that result in the impoundment of water or other liquids (e.g. retention pond, waste lagoon, dam)? If Yes, explain purpose and size: _____ _____	NO	YES
19. Has the site of the proposed action or an adjoining property been the location of an active or closed solid waste management facility? If Yes, describe: _____ _____	NO	YES
20. Has the site of the proposed action or an adjoining property been the subject of remediation (ongoing or completed) for hazardous waste? If Yes, describe: _____ _____	NO	YES
I AFFIRM THAT THE INFORMATION PROVIDED ABOVE IS TRUE AND ACCURATE TO THE BEST OF MY KNOWLEDGE		
Applicant/sponsor name: <u>Christian Zimmerman</u>		Date: <u>4-19-16</u>
Signature: <u>Christian Zimmerman</u>		

Part 2 - Impact Assessment. The Lead Agency is responsible for the completion of Part 2. Answer all of the following questions in Part 2 using the information contained in Part 1 and other materials submitted by the project sponsor or otherwise available to the reviewer. When answering the questions the reviewer should be guided by the concept "Have my responses been reasonable considering the scale and context of the proposed action?"

	No, or small impact may occur	Moderate to large impact may occur
1. Will the proposed action create a material conflict with an adopted land use plan or zoning regulations?		
2. Will the proposed action result in a change in the use or intensity of use of land?		
3. Will the proposed action impair the character or quality of the existing community?		
4. Will the proposed action have an impact on the environmental characteristics that caused the establishment of a Critical Environmental Area (CEA)?		
5. Will the proposed action result in an adverse change in the existing level of traffic or affect existing infrastructure for mass transit, biking or walkway?		
6. Will the proposed action cause an increase in the use of energy and it fails to incorporate reasonably available energy conservation or renewable energy opportunities?		
7. Will the proposed action impact existing: a. public / private water supplies? b. public / private wastewater treatment utilities?		
8. Will the proposed action impair the character or quality of important historic, archaeological, architectural or aesthetic resources?		
9. Will the proposed action result in an adverse change to natural resources (e.g. wetlands, waterbodies, groundwater, air quality, flora and fauna)?		

	No. or small impact may occur	Moderate to large impact may occur
10. Will the proposed action result in an increase in the potential for erosion, flooding or drainage problems?		
11. Will the proposed action create a hazard to environmental resources or human health?		

Part 3 - Determination of significance. The Lead Agency is responsible for the completion of Part 3. For every question in Part 2 that was answered "moderate to large impact may occur", or if there is a need to explain why a particular element of the proposed action may or will not result in a significant adverse environmental impact, please complete Part 3. Part 3 should, in sufficient detail, identify the impact, including any measures or design elements that have been included by the project sponsor to avoid or reduce impacts. Part 3 should also explain how the lead agency determined that the impact may or will not be significant. Each potential impact should be assessed considering its setting, probability of occurring, duration, irreversibility, geographic scope and magnitude. Also consider the potential for short-term, long-term and cumulative impacts.

<input type="checkbox"/> Check this box if you have determined, based on the information and analysis above, and any supporting documentation, that the proposed action may result in one or more potentially large or significant adverse impacts and an environmental impact statement is required.	
<input type="checkbox"/> Check this box if you have determined, based on the information and analysis above, and any supporting documentation, that the proposed action will not result in any significant adverse environmental impacts.	
<hr/> Name of Lead Agency <i>Christian</i>	<hr/> Date
<hr/> Print or Type Name of Responsible Officer in Lead Agency	<hr/> Title of Responsible Officer
<hr/> Signature of Responsible Officer in Lead Agency	<hr/> Signature of Preparer (if different from Responsible Officer)

04/30/2016 8:11 AM FAX 16074459821
RECEIVED 05/02/2016 09:28 5872437764
FINGER LAKES PROPANE

TOMINFSTARKEY 0001/0001

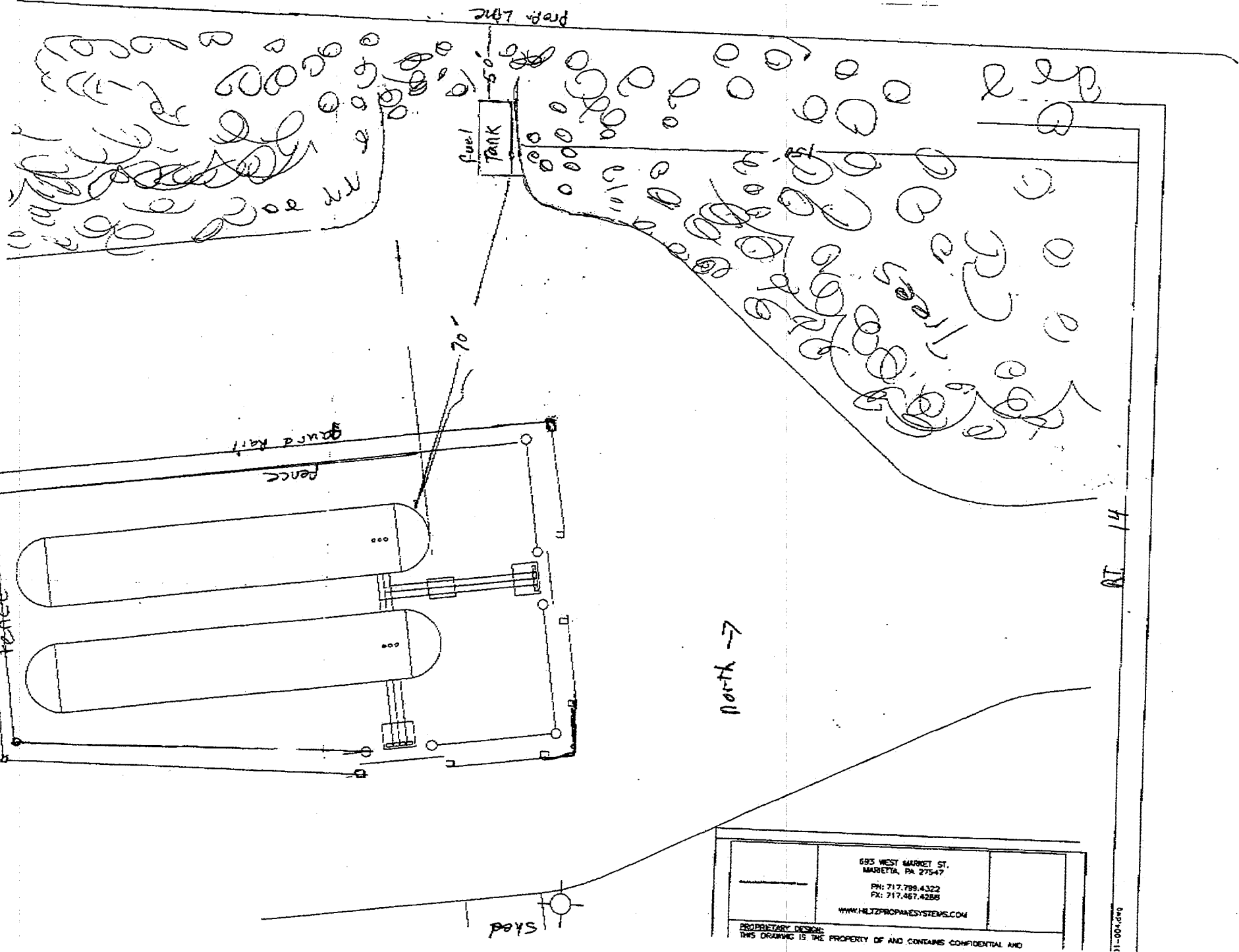

695 WEST MARKET ST. MARIETTA, PA 27547		
PH: 717.799.4322 FX: 717.667.4288		
WWW.HLTZPROPANE SYSTEMS.COM		
PROPRIETARY DESIGN: THIS DRAWING IS THE PROPERTY OF AND CONTAINS CONFIDENTIAL AND		

31-004-000

Tank Specs For Finger Lakes Propane Fuel TANK

TOMNOFSTARKEY 0001/0001

RECEIVED 05/02/2016 09:35 6072437764 FINGER LAKES PROPANE 04/30/2016 8:18 AM FAX 18074450821

STANWADE METAL PRODUCTS, INC.
 5368 State Route 305, P.O. Box 18
 Hartford, Ohio 44124
 Phone: 800-826-5243 Fax: 1-330-772-3307
 www.tankstore.com

Tank For Stationary Use Only

Capacity:	3,000 Gallons	Primary Heads:	7 Ga.	Paint Exterior:	Red Oxide Primer
Design:	Double Wall A.G.	Primary Shell:	7 Ga.	Paint Interior:	
Code:	LL 142	Secondary Heads:	7 Ga.	Weight Empty:	5,150 lbs.
Test Pres.	5 PSI	Secondary Shell:	10 Ga.	Revision #:	_____ Date: _____

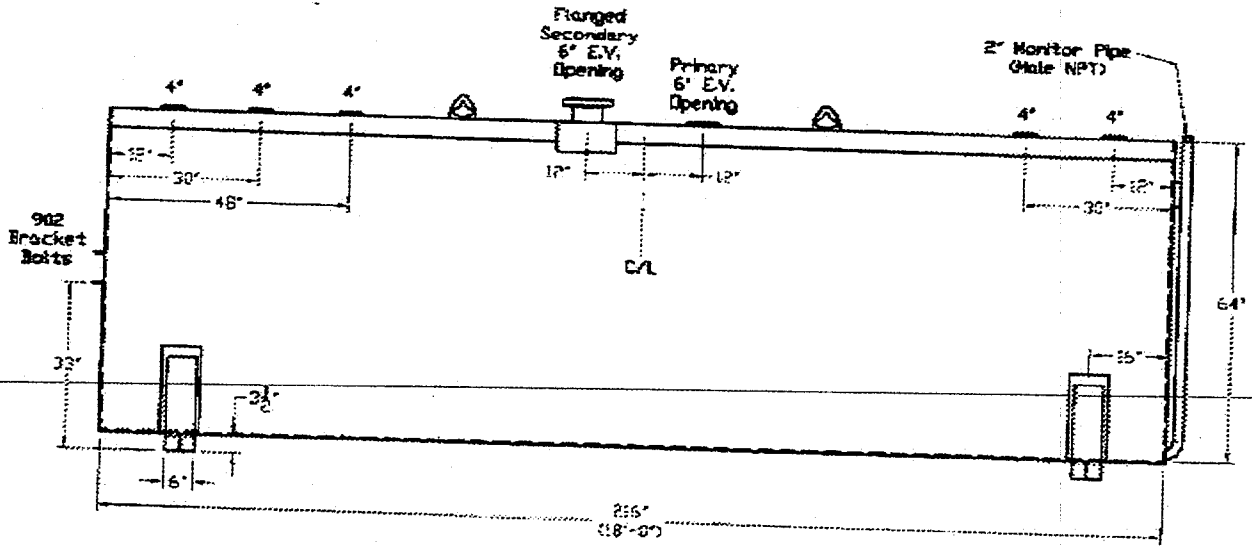

Customer: _____
 Drawing #: _____
 Quote #: _____

Drawing Date: _____

Quoted Lead Times Begin Upon Receipt of signed Approved Drawing. Which Must be Returned Before Production Can Begin.

Drawing Approved By: _____

From Lubricants Fuel Solutions 1.607.231.4032 Thu Apr 21 09:43:53 2016 MDT Page 2 of 2